

Serial Numbers 91/xxxx

1- Speed, 120 Volt, 1 Phase, 60Hz., 1/2 HP.
1725 RPM, 7.2 Amps

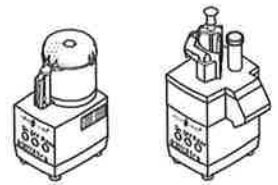

Phone: 1-800-824-1646
Fax: 601-898-9134
email: robocoup@misnet.com

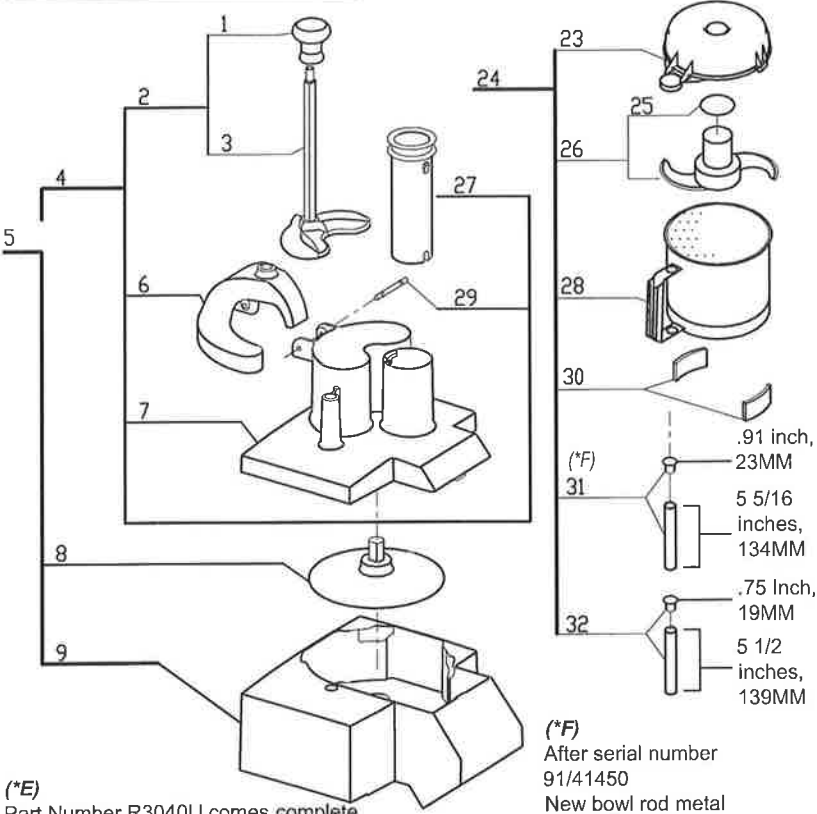

(*E) Part Number R3040U comes complete with magnetic switch. After serial number 91/30xxx use new PC board number R3040UA which includes magnetic switch number R3061A.

(*F) After serial number 91/41450 New bowl rod metal bushings R3071UA replaces rod with plastic caps.

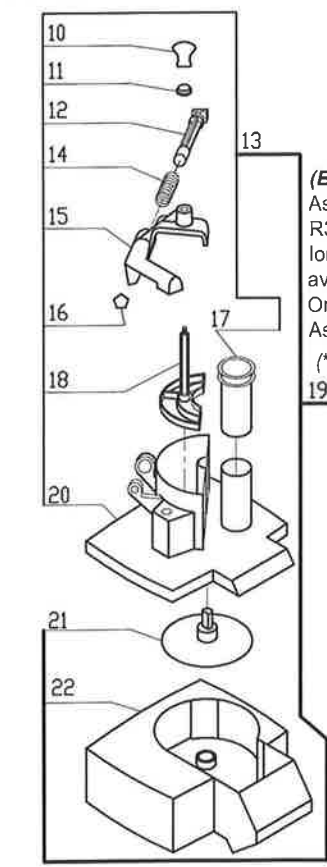
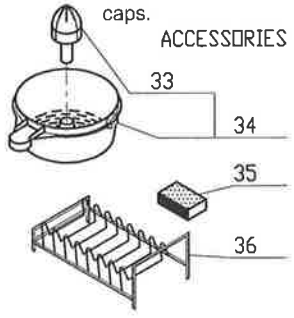

(B) Assembly R3056A is no longer available. Order 27213 Assembly (*B) 19

(*A) Part No Longer Available

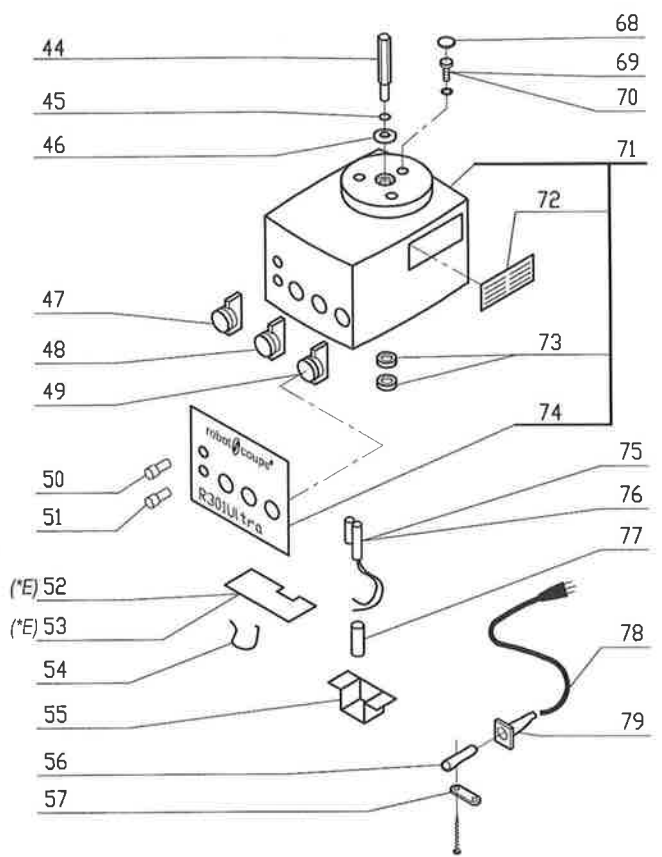
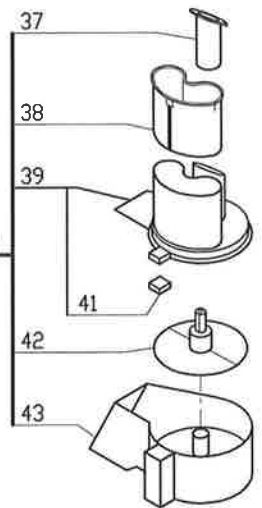

(*E) 52
(*E) 53

CONVERSION KIT: R3006K
1-R3006UB-Magnetek Motor
1-R3004B
3-R3025A
2-R1716
1-R222

(*D) Use conversion kit R3006K to replace open frame motor of R301U. Serial Numbers 91/00001 to number 91/20000:

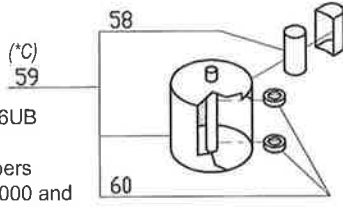

(*C) R3006UB Serial Numbers 91/20000 and above (Magnetek Motor).

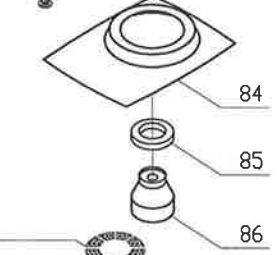
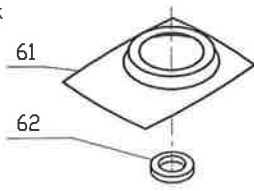
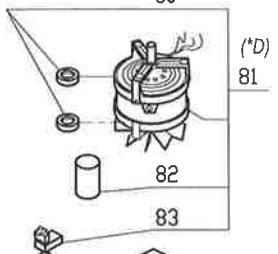

63 Canada Only
64 Canada Only

(*F) After serial number 91/41450

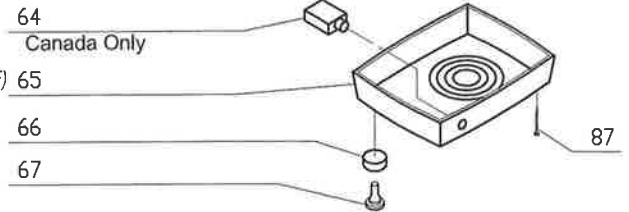

INDEX	REF.	DESIGNATION	Pricelist in USD
1	102021	Pusher Knob	
2	29880	(C) Large Pusher Assy R300,R301U Srs "C"	
3	103703	(C) Large Pusher Only R300,R301U Srs "C"	
4	29922	(C) Cont Feed Lead Assy R300,R301U Srs C	
5	27213	* (C) Cont. Feed Kit (Series "C")	
6	29921	(C) Pusher Guide R300,R301U Series "C"	
7	103534	(C) Cont Feed Lead Only R300,R301U "C"	
8	100954	Discharge Plate	
9	103728	(C) Cont Feed Attach. R300,R301U Srs "C"	
12	100963	Pin, Pusher Return	
13	29369	Cont Feed Lead w/Lg Pshr	
14	101054	Spring, Pusher Return	
15	100952	Hinged Bracket,Lg Pusher	
16	203011	Retaining Clip for Pin	
17	100955	Small Pusher	
18	29157	Large Pusher with Rod	
19	NLA	No longer available	
20	100950	Cont. Feed Lead	
22	100951	Continuous Feed Attachmt	
23	39380	Bowl Lid	
24	27014	* Bowl Kit (S. Steel)	
25	117058	45mm Blade Cap, White	
26	38150	* S Blade (Straight)	
27	118324	(L)Small Pusher	
28	29149	Bowl/Stainles Steel	
29	103540	(C) Pusher Pivot Pin R300,R301U Series C	
30	29081	Lckg Bush Set W/Screws	
33	117599	Juicer Cone	
34	27172	* Juicer Kit	
35	502579	Honing Stone	
36	R255	PLATE RACK	
41	508530	Magnet	
42	125048	Discharge Plate	
43	29015	Continuous Feed Atchmnt	
44	100082	Shaft Extension,Motor	
46	100084	Deflector Washer SS	
47	500322	On Push Button/Green	
48	500321	Off Push Button (Red)	
49	500301	Pulse Push Buttn,Black	
50	500323	Power On (red or white)	
51	500324	Green Lamp	
52	29049	Electrical Board	
53	29226	Electrical Board w/Sw Hs	
54	500621	Jumper Wire, PCB	
55	127589	Shield	
57	108515	Strain Relief	
58	R222	CAPACITOR F/C MOTOR (R2N)	

INDEX	REF.	DESIGNATION	Pricelist in USD
59	R3006UB	Motor (Century)	
60	R237	BEARING, MOTOR BOTTOM	
61	125246	Baffle Plate	
62	101033	Btm Cushion Bushing,Cent	
63	R3072	Screen Kit (Canada Only)	
64	R286	CIRCUIT-BREAKER	
66	102031	Foot	
67	100642	Foot	
68	100095	Screw Cover	
69	202851	Motor Support Screw	
70	R3025A	Screw, MS Cent Mtr	
71	29420	Motor Support	
72	125290	Grill	
73	501327	Motor Support Seal	
74	400177	Data Plate	
75	29079	Magnetic Switch/R122AA	
76	39358	Switch w/Housing	
78	R240	POWER CORD	
79	508706	Rubber Cord Sleeve	
80	600457	6201 Bearing	
81	R3006K	Mtr Conv Kit(SA301U-Cent	
82	603669	Capacitor/180MF 120/160	
83	500296	Relay MTRPH - 16/39	
84	125136	Baffle Plate	
85	130141	Bottom Cushion Bushing	
86	127578	Btm Cushion Bush Support	
87	R3002	Base Screws	